

# ELDORADO STONE® FINISHING DETAILS

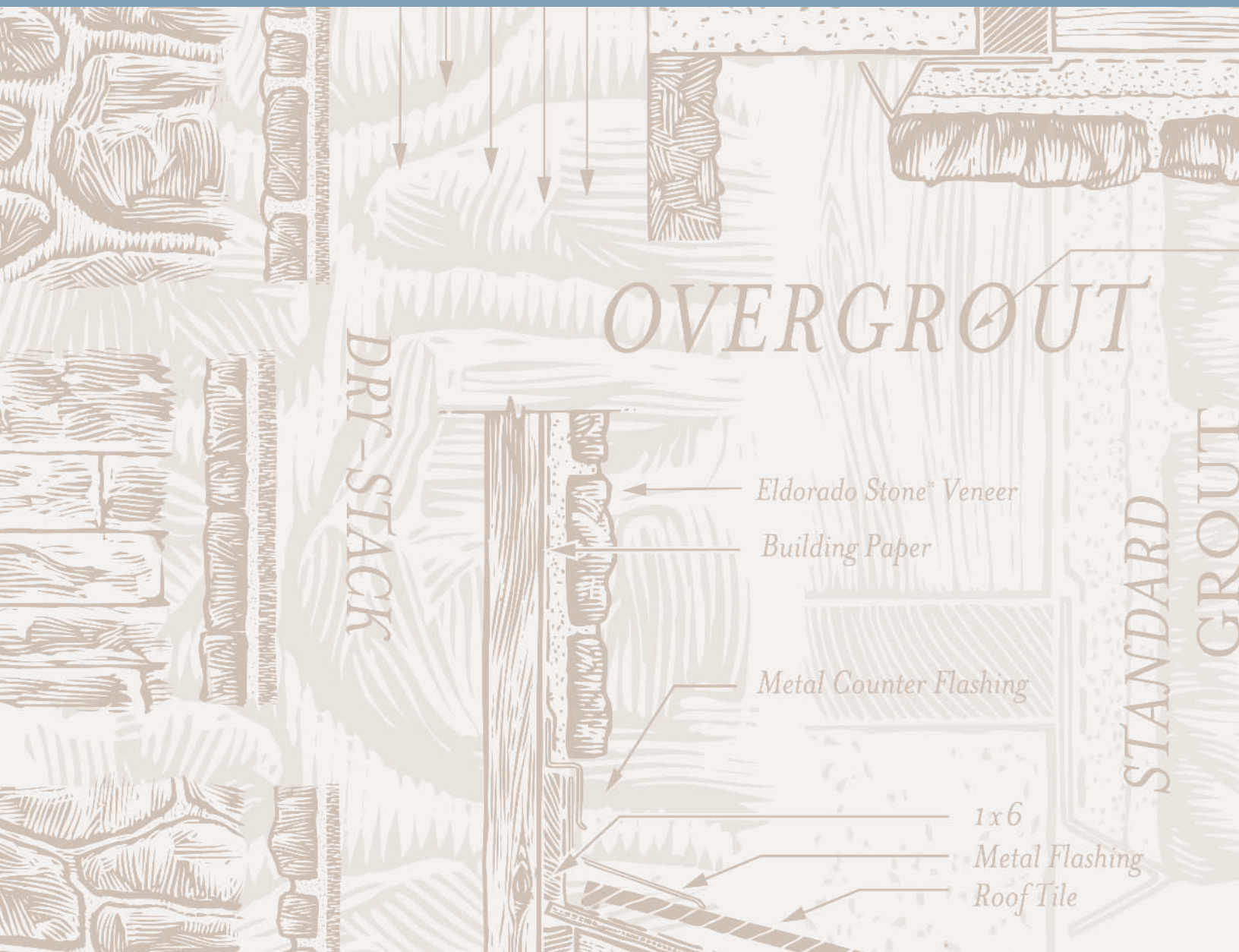

# Building Po

Believability has always been the ultimate goal of the craftsmen of Eldorado Stone®. As our product line has developed, so has our understanding of what it takes to achieve the true art of stone masonry. The following pages are intended to share with you what we have learned about the installation of manufactured veneer products. Given this, we present the following information to assist you in your creative endeavors.

# TRANSITION DETAILS

In addition to the five basic substrate application details that we have illustrated in our *Installation Procedures* brochure, we are often asked for additional construction details for our architectural veneers. The following seventeen diagrams are ideas when veneer transitions are needed. Compiled from the finest architects' and developers' drawings, these details are the creative solutions you need to finish a job right the first time.

When Eldorado Stone® veneer flats and corners are used together, a variety of simple and cost-effective solutions are possible. These drawings show how depth, dimension and believability can be achieved by following a few simple steps and a few tricks of the trade.

*NOTE: The following construction details on pages 4 through 6 are provided as ideas for solutions to architectural designs. They will not necessarily apply to the specific design circumstances you may encounter. These construction details may, and probably will, require changes to meet your particular design requirements. Manufacturer accepts no responsibility or liability for the use of these or other construction details.*

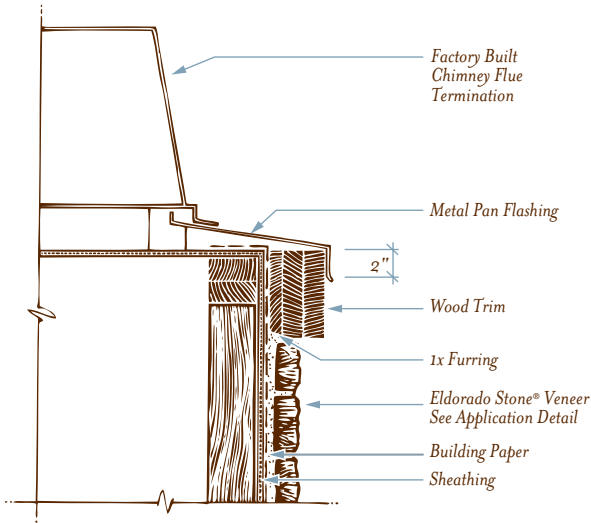

**CHIMNEY CAP**

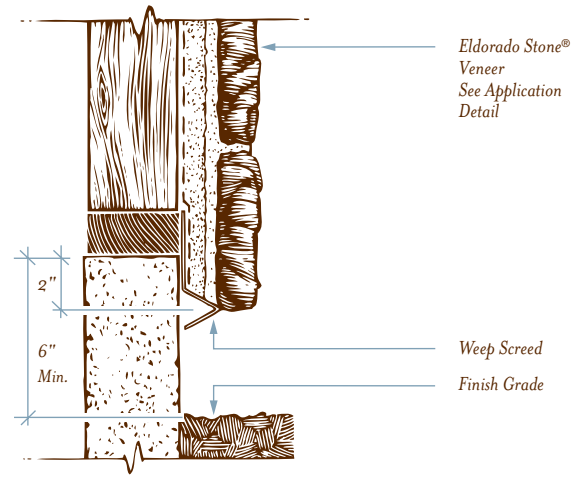

**WEEP SCREED**

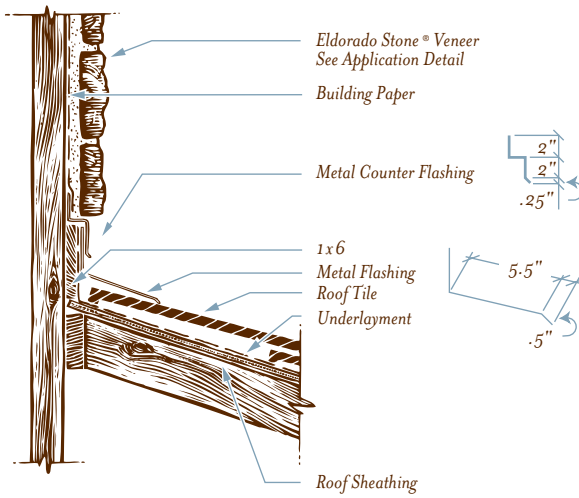

**TRANSITION Roof to Wall**

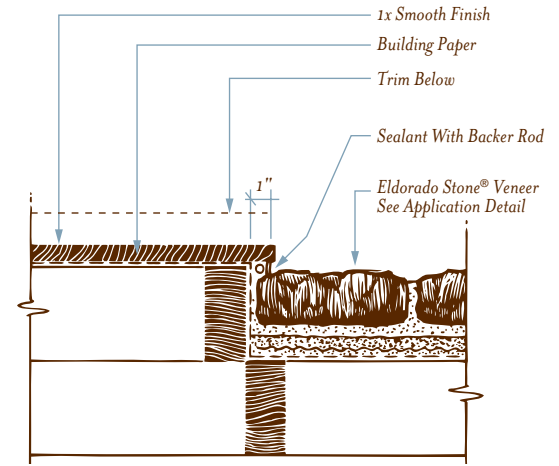

**TRANSITION Stone Siding**

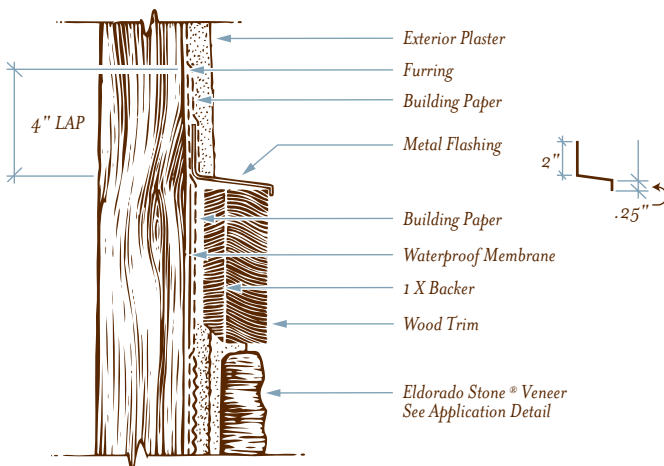

**TRANSITION Wood Trim**

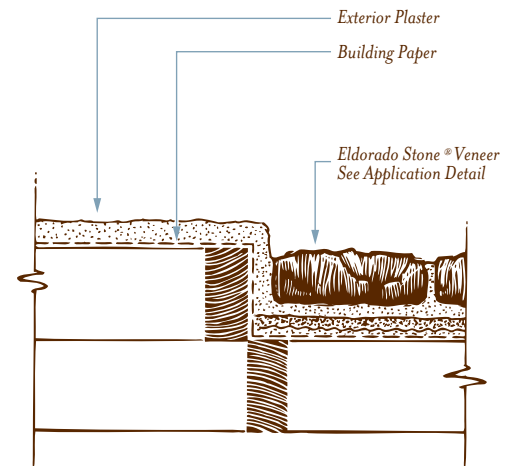

**TRANSITION Stone-Plaster**



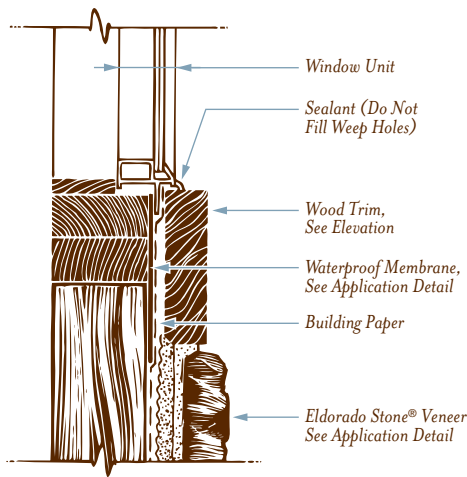

**WINDOW SILL** Wood Trim

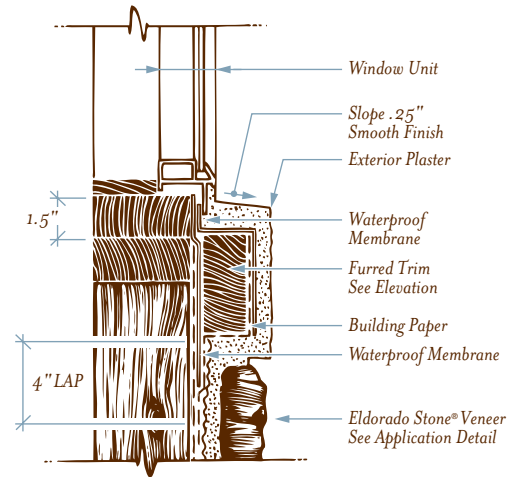

**WINDOW SILL** Furred Trim

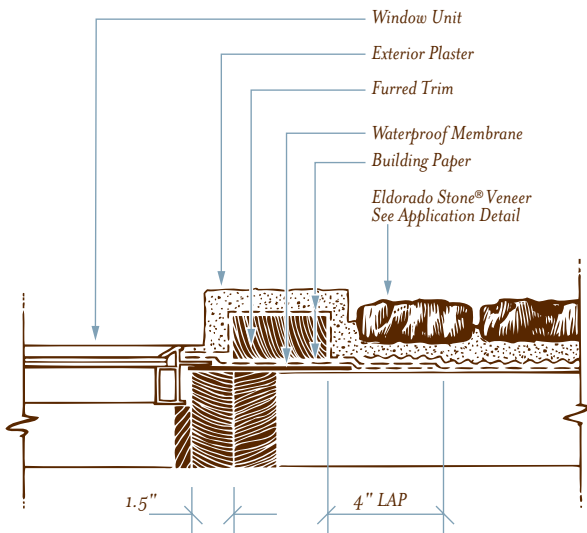

**WINDOW JAMB** Furred Trim

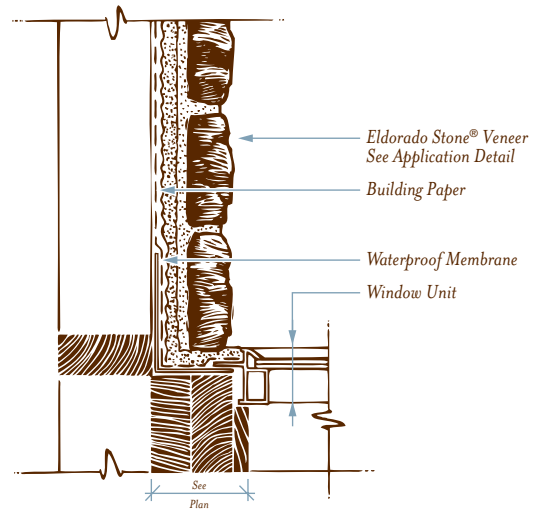

**WINDOW JAMB**

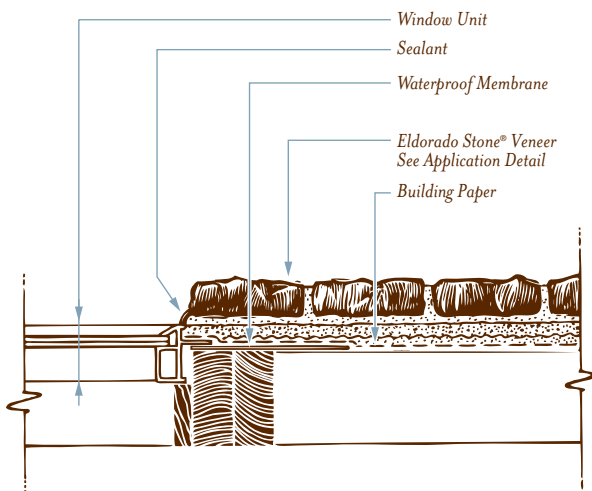

**WINDOW JAMB** Flush Termination

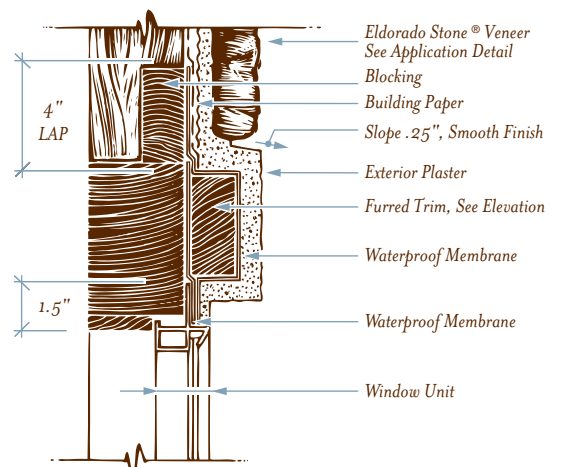

**WINDOW HEADER** Furred Trim

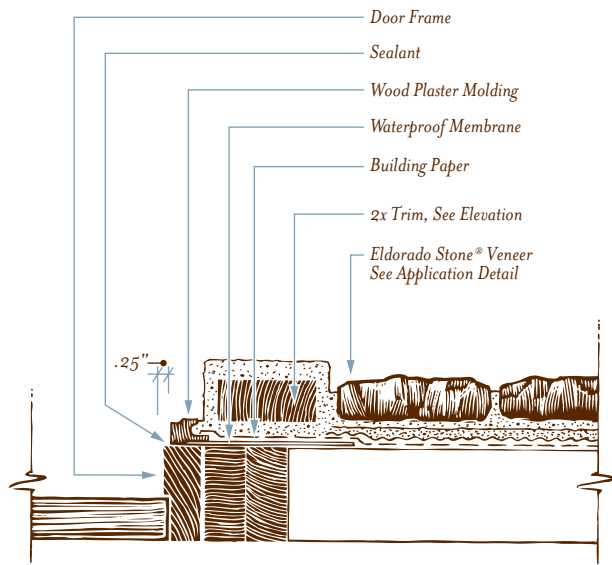

**DOOR JAM Furred Trim**

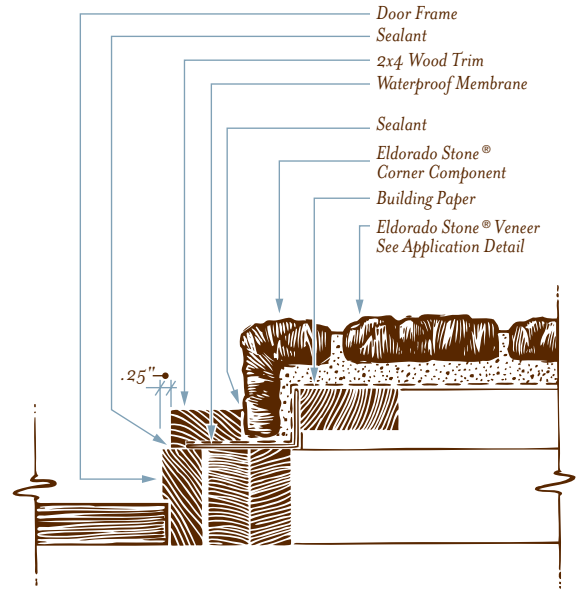

**DOOR JAM Corner Return**

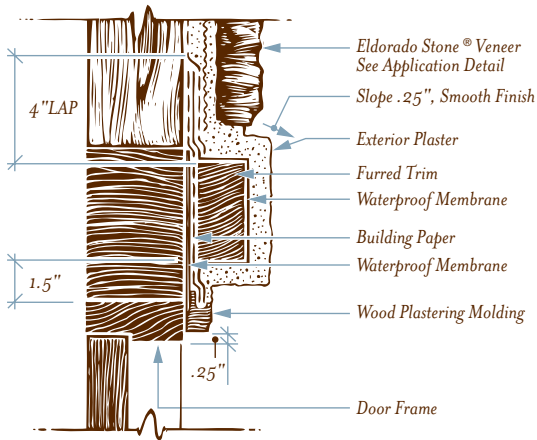

**DOOR HEADER Furred Trim**

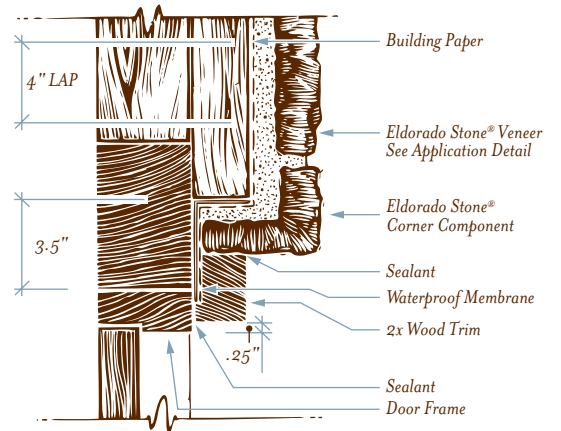

**DOOR HEADER Corner Return**

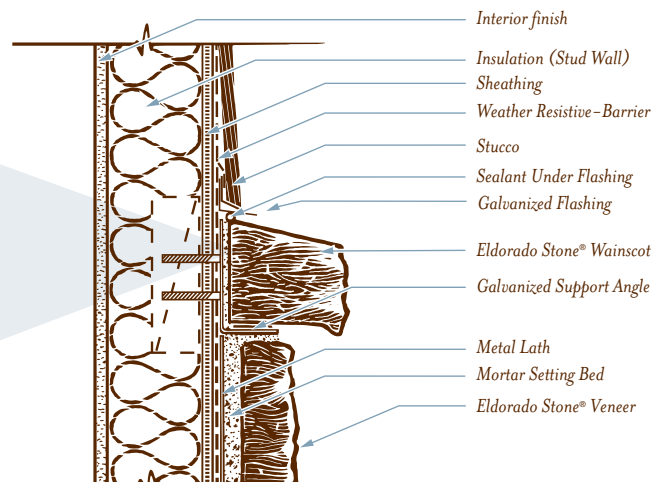
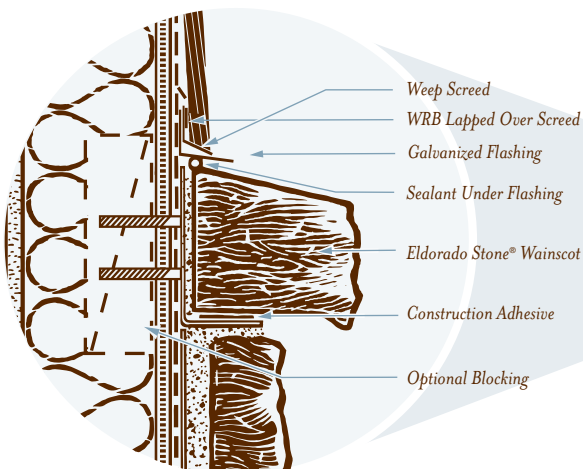

**WAINSCOT SILLS**

# GROUT TECHNIQUES

---

Selecting the appropriate grout technique is just as important as installing the stone properly. The grout style should be chosen before installing any of the Eldorado Stone® veneer profiles.

The following finished grout details are three of the most commonly used techniques. The Standard (Raked) or Full Joint, the Dry-stack and the Overgrout Joint each have their own unique look which play an important role in the finished details of a veneer installation that has the look and feel of real stone.

## *Grout Tips*

---

*Always keep the face of the stone clean (unless you want a slurry finish) because smeared mortar may permanently stain the stone.*

*You can, and many times should, add color to the mortar to more closely match the stone. Care should be taken to be assured that the color emulates a natural earthen sand color. Also, be aware of the geographic properties of different ingredients.*

*Joints can be tooled with specific masonry tools or with anything you find easy to use — a stick or your fingers. If it works, use it!*

*Don't allow joints to fully harden before tooling. Mortar should be pliable and crumbly, not too wet and not too dry.*

*Overgrout joints can be tooled (somewhat) earlier than raked joints.*

*Don't grout more than you can manage at one time.*

*Using a grout bag is much easier than hand "tucking" the joints.*

*Timing is everything.*



*Elevation*



*Cross Section*



*Elevation*



*Cross Section*

### STANDARD JOINT (RAKED)

A standard joint (raked) is achieved by laying each veneer piece roughly one finger width apart from each other, then grouting between each veneer piece. The semi-dry mortar is later “raked” with a variety of tools ultimately achieving a consistent depth and giving it that distinctive raked out look.

### FULL JOINT

A full joint is similar to a standard joint, however, the grout level is flush with the face of the veneer. A full joint differs from an overgrout joint because the grout does not actually overlap the face of the veneer.

*More variation occurs in the topography of the veneer’s surface since the mortar is struck back to a consistent plane depth.*

*Only grout as much as you can manage.*

*More of the veneer’s face shows than with overgrout.*

*Run your finger over the grout — if it crumbles it is ready to be raked.*

*While viewing a cross section of the job visualize the mortar as a single plane.*

*Maintain the same depth of mortar — approximately 0.5" below the veneer’s face.*

### OVERGROUT JOINT

Overgrout, an increasingly popular way to achieve an old-world look, is sometimes referred to as sack finish — a name derived from old-timers who used burlap sacks to smooth mortar to a plane flush with the veneer’s face. Today, trowels, tuck pointers — even fingers — are used to achieve the overgrouted or sacked look. This technique tends to make the masonry appear rustic and aged. The grout overlaps the face of the veneer, widening the joints and making them very irregular. This old-world technique connotes different things to different people so make sure and have your mason prepare a mock-up before beginning any actual work.

*It’s important that the joint’s mortar be applied without air pockets and are filled completely to the substrate.*

*Overfill joints when applying grout.*

*Veneer’s surface appears more uniform (topographically) because the mortar joint is closer to the face of the veneer.*

*Mortar should be right between being too wet and too crumbly.*

*The overgrout technique uses almost every veneer piece shipped because broken edges can be hidden by grout.*

*Use a trowel for a tempered, more faceted finish.*



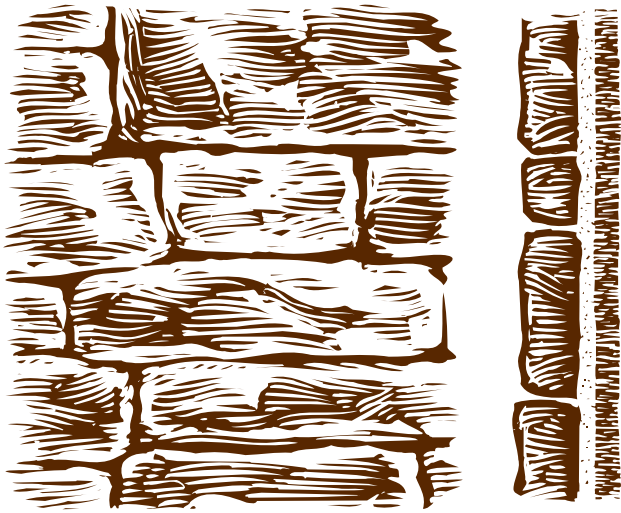

Elevation

Cross Section

## DRY-STACK JOINT

A dry-stack joint technique is accomplished by “dry” fitting each veneer piece prior to installation. Each piece can be laid with virtually no joint. Even though you’ve used mortar to set the veneer to the surface, when complete, the finished look will appear as though no mortar was used to install the veneer. The intent of a dry-stack look is a tightly stacked natural stone appearance.

Since it is intended to look like each veneer piece has been laid on top of each other, it is not necessary to grout dry-stack installations around each veneer piece. However, it is important that every veneer piece is installed with a full coverage of mortar on the backside and that the perimeter of each veneer piece is sealed with mortar.

*It is sometimes desirable to do touch-up grouting to fill noticeable voids where the veneer is not a perfect fit and to conceal the appearance of cut or broken veneer edges.*

*To maintain a horizontal orientation, minute adjustments in spacing might be necessary.*

*If a veneer piece’s edge is to be hidden, be sure to trim that piece — or “back cut” it — at an angle.*

*Use compressed air to dust out joints where brushes don’t reach.*

*Dry-stack joints should not be used in the application of Eldorado Brick® or Eldorado Adobe®.*

## General Observations

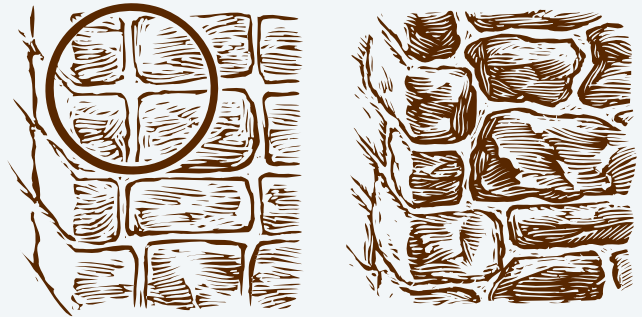

*Careful! Avoid the “+ sign” pattern (left) that can occur if installed awkwardly by locating pieces so grout joints are staggered (right).*

Always have your mason prepare a mock-up of the grout finish you wish to use (standard, full, dry-stack or overgrout) prior to beginning the actual installation. Make sure you understand how he intends to finish the joints. All the veneer shipped to the site should be placed face up over an area so a mental inventory of the sizes, shapes and colors can take place. Many profiles require a rationing of certain veneer pieces throughout the entire process. Start at the corners and edges of the surfaces to be veneered and work inward. This will reduce the amount of cutting required to fit pieces.

*Adverse weather conditions affect manufactured veneer during installation.*

*Alternate corner colors and shapes.*

*Avoid any “+ signs” in the joints (see illustration).*

*Metal tools that strike the mortar breaks the skin which will cause moisture to rise and accelerate the drying time. It will also “polish” the grout.*

# ACCENT COLOR RECOMMENDATIONS

## NATIONWIDE PROFILES

PROFILE	PROFILE COLOR	RECOMMENDED ACCENT COLOR
<i>Ashlar</i>	Bedford	Earth
	Fairmont	Earth, Smoke
	Santa Barbara	Buckskin
<i>Bluffstone™</i>	Bodega	Earth, Taupe
	Coos Bay	Smoke
	La Plata	Buckskin
	Mineret	Buckskin, Earth, Taupe
	Prescott	Buckskin, Smoke
<i>Cliffstone®</i>	Cambria	Buckskin, Earth
	Lantana	Buckskin, Earth, Smoke, Taupe
	Manzanita	Buckskin
	Mesquite	Buckskin
	Montecito	Smoke
	Ponderosa	Taupe
<i>Country Rubble™</i>	Bella	Buckskin
	Capri	Buckskin, Earth, Smoke
	Cognac	Buckskin, Earth, Smoke, Taupe
	Polermo	Earth, Smoke, Taupe
<i>Cypress Ridge™</i>	Countryside	Buckskin, Smoke, Taupe
	Orchard	Buckskin, Earth, Taupe
	Summerhouse	Buckskin, Taupe
<i>Fieldledge®</i>	Andante	Smoke
	Meseta	Smoke, Taupe
	Padova	Earth
	Umbria	Buckskin
	Veneto	Earth, Taupe
<i>Hillstone®</i>	Bergamo	Buckskin, Smoke
	Lucera	Buckskin, Smoke
	Molano	Buckskin
	Verona	Smoke, Taupe
<i>Limestone</i>	Castillo	Buckskin
	San Marino	Buckskin, Smoke
	Savannah	Buckskin, Earth, Taupe
	Shilo	Buckskin, Earth, Taupe
	York	Buckskin, Smoke

PROFILE	PROFILE COLOR	RECOMMENDED ACCENT COLOR
<i>Mountain Ledge</i>	Bitterroot Durango Mesa Verde Shasta Sierra Yukon	Earth, Taupe Buckskin, Earth, Taupe Earth, Taupe Smoke Buckskin, Earth, Smoke Buckskin
<i>Mountain Ledge Panels</i>	Pioneer Russet Silverton	Buckskin Buckskin, Earth, Taupe Smoke
<i>River Rock</i>	Colorado Rainier Rio Grande Saginaw Yakima	Buckskin Buckskin Buckskin Buckskin, Taupe Buckskin, Taupe
<i>RoughCut™</i>	Autumn Leaf Vineyard Trail Wheatfield	Buckskin, Earth Buckskin, Smoke Buckskin
<i>Rustic Ledge®</i>	Cascade Clearwater Saddleback Saratoga Sawtooth Sequoia	Buckskin Smoke Smoke Buckskin, Smoke Buckskin, Earth, Taupe Buckskin
<i>Shadow Rock</i>	Bronze Chesapeake Shenandoah Somerset Teton	Buckskin, Taupe Smoke Buckskin, Earth, Taupe Buckskin, Smoke Buckskin, Smoke
<i>Stacked Stone</i>	Alderwood Castaway Chapel Hill Nantucket Pagosa Springs Santa Fe	Buckskin, Smoke Earth, Taupe Smoke Buckskin, Smoke Buckskin, Earth Earth, Taupe
<i>Top Rock</i>	Buckhorn Dakota La Quinta Montana	Earth, Taupe Earth, Taupe Earth, Taupe Buckskin, Smoke

# ACCENT COLOR RECOMMENDATIONS

## EASTERN PROFILES

PROFILE	PROFILE COLOR	RECOMMENDED ACCENT COLOR
<i>Bluffstone™</i>	Olive Grove	Buckskin, Earth
	Woodlands	Buckskin, Earth
<i>Castle Stone</i>	Eastridge	Buckskin, Earth
	Springfield	Earth
<i>CoastalReef™</i>	Pearl White	Buckskin
	Sanibel	Buckskin
<i>Country Rubble™</i>	Alderidge	Earth
	Berkshire	Earth
	Millstream	Earth
	River Gorge	Earth
<i>Granite</i>	Columbia	Earth
	Mackinac	Earth
<i>Ledge Quartz™</i>	Grandview	Smoke
	North Peak	Earth
<i>Limestone</i>	Bridgeport	Buckskin, Earth
	New Haven	Earth
<i>Mountain Ledge</i>	Asheville	Earth, Smoke
	Charleston	Earth, Taupe
	Chestnut Ridge	Earth
	Lexington	Earth
	Timberwood	Buckskin, Earth
	Walnut Ridge	Earth, Smoke
<i>River Rock</i>	Superior	Earth, Smoke
<i>Shadow Rock</i>	Crescent Peak	Smoke
	Ironwood	Smoke
	Willow	Buckskin, Earth
<i>Weather Edge™</i>	Amber Falls	Buckskin, Smoke
	Deerfield	Buckskin, Earth

## WESTERN PROFILES

PROFILE	PROFILE COLOR	RECOMMENDED ACCENT COLOR
<i>Coarsed Stone™</i>	Santa Barbara	Buckskin
<i>Coastal Ledge™</i>	La Jolla Santa Barbara Santa Cruz	Buckskin Buckskin Buckskin, Earth
<i>CoastalReef™</i>	Pearl White Sanibel	Buckskin Buckskin
<i>Cobblestone</i>	Coal Canyon Newport Tombstone	Smoke Buckskin Buckskin
<i>Country Rubble™</i>	Bordeaux Chateau English	Buckskin, Earth Buckskin Smoke
<i>Creek Cobble®</i>	American Blend Sierra Yosemite	Smoke Buckskin, Earth Buckskin
<i>Limestone</i>	Appalachian Austin Cream Monterey Rincon	Buckskin, Smoke Buckskin Buckskin Earth, Taupe
<i>Mountain Ledge</i>	Buckskin Oakridge	Buckskin Buckskin
<i>Quarystone®</i>	Jackson Valley	Buckskin, Earth
<i>River Rock</i>	American Blend Sierra Sonoma Yosemite	Smoke Buckskin, Earth Earth, Taupe Buckskin
<i>Rustic Ledge®</i>	Pine Top Prairie	Buckskin Buckskin
<i>Sandstone</i>	Santa Barbara	Buckskin
<i>Stacked Stone</i>	Slate Gray	Smoke
<i>Weather Edge™</i>	Napa Valley Western Wisconsin	Smoke Buckskin



# ACCENT COLOR RECOMMENDATIONS

## NORTHWESTERN PROFILES

PROFILE	PROFILE COLOR	RECOMMENDED ACCENT COLOR
<i>Broken Top</i>	K-West Willamette	Smoke Earth
<i>Cobblestone</i>	Brown Gray	Buckskin Smoke
<i>Limestone</i>	Mt. St. Helens Sacramento	Smoke Buckskin, Earth
<i>Monarch</i>	Northwest Flintstone	Smoke
<i>Mountain Ledge Panels</i>	China Copper Warm Springs	Buckskin, Earth Buckskin Buckskin, Earth
<i>Quartz</i>	Cascade	Buckskin, Taupe
<i>River Rock</i>	Mountain Blend Northwest	Buckskin, Earth Buckskin
<i>Shadow Rock</i>	Cascade	Buckskin
<i>Stacked Stone</i>	China Mountain Olympic	Buckskin, Smoke Buckskin
<i>Vintage Manor™</i>	London Yorkshire	Smoke Buckskin
<i>Weather Edge™</i>	Northwestern Wisconsin	Buckskin, Earth

THE PRODUCTION MATERIALS SELECTED FOR THIS BROCHURE REFLECT OUR DESIRE TO PRODUCE ENVIRONMENTALLY-FRIENDLY PRINTED MATERIALS

This publication is printed on FSC-certified Fox River Paper (Evergreen) which is made with elemental-chlorine-free, 100% post-consumer recycled fiber. This paper is Rainforest Alliance certified ([www.rainforest-alliance.org](http://www.rainforest-alliance.org)) and was manufactured using Forest Stewardship Council (FSC) standards which promote responsible management of the world's forests. Soy-based inks were also used in production to ensure that hazardous air pollutants and volatile organic compounds were omitted. *Listed below are the environmental savings derived from using 100% post-consumer recycled fiber:*



**31**  
trees preserved  
for the future



**11,148**  
gallons of  
wastewater  
flow saved



**21,000,000**  
BTUs of energy  
not consumed



**2,686**  
lbs. of air emissions  
not generated



**1,432**  
lbs. of solid waste  
not generated



TRANSITION



**A HEADWATERS COMPANY**

---

1370 GRAND AVENUE, BUILDING B

SAN MARCOS, CA 92078

1.800.925.1491

[WWW.ELDORADOSTONE.COM](http://WWW.ELDORADOSTONE.COM)